

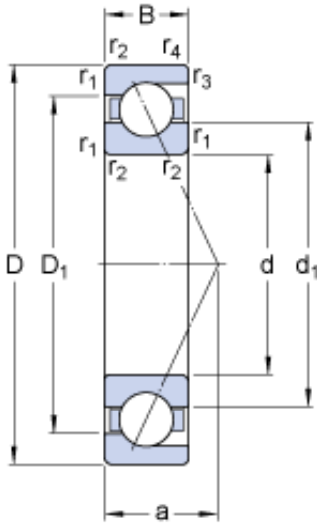

TIF bearing co.,ltd



71968 ACMB Bearing 2D drawings and 3D CAD models

SKF 71968 ACMB angular contact ball bearings

Bearing No. 71968 ACMB

Size	460x340x56 mm
Bore Diameter	460 mm
Outer Diameter	340 mm
Width	56 mm
d	340 mm
D	460 mm
B	56 mm
d ₁	380 mm
D ₁	422 mm
a	126 mm
r _{1,2} - min.	3 mm
r _{3,4} - min.	1.1 mm
d _a - min.	353 mm
D _a - max.	447 mm
D _b - max.	453 mm
r _a - max.	2.5 mm
r _b - max.	1 mm
Basic dynamic load rating - C	338 kN
Basic static load rating - C ₀	585 kN
Fatigue load limit - P _u	12.5 kN
Reference speed	1500 r/min
Limiting speed	1500 r/min
Calculation factor - k _r	0.083
Calculation factor - k _a	0.25
Calculation factor - e	0.68



TIF bearing co.,ltd

Calculation factor - X	0.41
Calculation factor - Y_0	0.38
Calculation factor - Y_1	
Calculation factor - Y_2	0.87
d_1	380 mm
D_1	422 mm
$r_{1,2}$ min.	3 mm
$r_{3,4}$ min.	1.1 mm
d_a min.	353 mm
D_a max.	447 mm
D_b max.	453 mm
r_a max.	2.5 mm
r_b max.	1 mm
Basic dynamic load rating C	338 kN
Basic static load rating C_0	585 kN
Fatigue load limit P_u	12.5 kN
Calculation factor A	1.78
Calculation factor k_r	0.083
Calculation factor e	0.68
Calculation factor X	0.41
Calculation factor Y_0	0.38
Calculation factor Y_2	0.87
Mass bearing	24 kg